

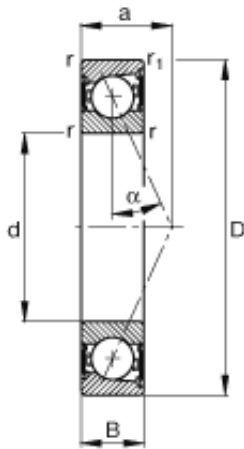

BEARING Driveshaft USA CORP.



40 mm x 62 mm x 12 mm FAG B71908-E-2RSD-T-P4S angular contact ball bearings

Bearing No. B71908-E-2RSD-T-P4S

B71908-E-2RSD-T-P4S Bearing 2D drawings and 3D CAD models

Size	40x62x12 mm
Bore Diameter	40 mm
Outer Diameter	62 mm
Width	12 mm
d	40 mm
D	62 mm
B	12 mm
a	18 mm
D_a	58,5 mm / Tolerance: H12
d_a	45 mm / Tolerance: h12
$r_{1 \text{ min}}$	0,6 mm
$r_{a \text{ max}}$	0,6 mm
$r_{a1 \text{ max}}$	0,6 mm
r_{min}	0,6 mm
	25 ° / Angle
m	0,103 kg / Weight
C_r	17100 N / Dynamic load rating (radial)
C_{0r}	9400 N / Static load rating (radial)
$n_{G \text{ Fett}}$	20000 1/min / Limiting speed for grease lubrication