

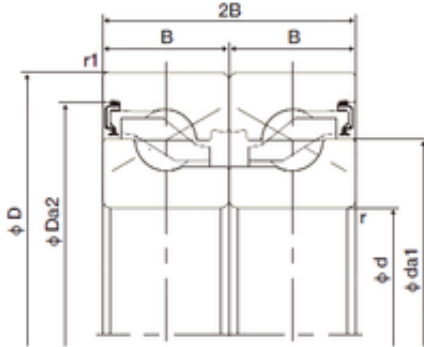

## BEARING Driveshaft USA CORP.

### 25 mm x 62 mm x 15 mm NACHI 25TAB06DB-2NK thrust ball bearings



25TAB06DB-2NK Bearing 2D drawings and 3D CAD models

Bearing No. 25TAB06DB-2NK

Size	25x62x15 mm
Bore Diameter	25 mm
Outer Diameter	62 mm
Width	15 mm
d	25 mm
D	62 mm
B	15 mm
C	15 mm
Angle ( ° )	60 °
r min.	1 mm
r1 min.	0.6 mm
2B	30 mm
Weight	0.24 Kg
Basic dynamic load rating (C)	29,9 kN
Basic static load rating (C0)	46,4 kN
Enclosure	Double Seal
Configuration	Double Row
Bore Type	Cylindrical Bore
Bore Size	25 mm
Outside Diameter	62 mm
Width	15 mm
Fillet Radius/Chamfer	1 mm
r1	0.6 mm
Dynamic Load Rating	6,700 N
Static Load Rating	10,400 N



## BEARING Driveshaft USA CORP.

Limiting Speed - Oil	3,250 rpm
Starting Torque - Grease Lubrication	20 N · cm
Da1	47.5 mm
Da2	54.9 mm
da1	46.2 mm
da2	39.7 mm