

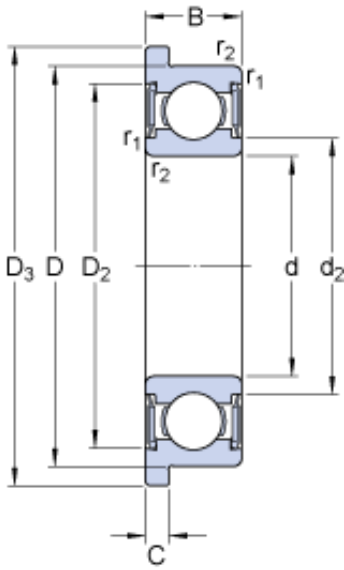

BEARING Driveshaft USA CORP.



W 605 R-2RS1 Bearing 2D drawings and 3D CAD models

5 mm x 14 mm x 5 mm SKF W 605 R-2RS1
deep groove ball bearings

Bearing No. W 605 R-2RS1

Size	14x5x5 mm
Bore Diameter	14 mm
Outer Diameter	5 mm
Width	5 mm
d	5 mm
D	14 mm
B	5 mm
d ₂	7.119 mm
D ₂	12.2 mm
D ₃	16 mm
C	1 mm
r _{1,2} - min.	0.2 mm
d _a - min.	6.4 mm
r _a - max.	0.2 mm
Basic dynamic load rating - C	0.761 kN
Basic static load rating - C ₀	0.26 kN
Fatigue load limit - P _u	0.011 kN
Limiting speed	30000 r/min
Calculation factor - k _r	0.03
Calculation factor - f ₀	6.6
d ₂	6.9 mm
D ₂	12.2 mm
D ₃	16 mm
r _{1,2} min.	0.2 mm



BEARING Driveshaft USA CORP.

d_a min.	6.6 mm
d_a max.	6.8 mm
r_a max.	0.2 mm
Basic dynamic load rating C	0.761 kN
Basic static load rating C_0	0.26 kN
Fatigue load limit P_u	0.011 kN
Calculation factor k_r	0.03
Calculation factor f_0	6.6
Mass bearing	0.0038 kg